

Welcome to the Art Gallery of Nova Scotia

The Art Gallery of Nova Scotia is an inclusive public gathering place that connects people with art to inspire new ways of thinking. Seeking to present the most vital and engaging contemporary art from around the world, we are committed to embracing the past by applying a contemporary viewpoint that addresses relevant issues and challenges perspectives. With nearly 19,000 works in the Permanent Collection, the Art Gallery of Nova Scotia is Atlantic Canada's largest art museum.

Protect the Art



Please do not touch artworks or consume food and drinks in exhibition spaces.



Large bags, backpacks, umbrellas, and pens are not permitted in exhibition spaces. We offer a complimentary coatroom and secure lockers for your valuables. Please be mindful of your surroundings in exhibition spaces.



Personal photography is permitted, unless otherwise noted, but please turn off your flash as artworks are sensitive to light.

Accessibility



The Gallery is wheelchair accessible with elevators in both buildings. Service dogs are permitted. The Gallery participates in the Easter Seals Canada Access 2 Card program that offers free admission for the companion of those visitors with permanent disabilities who require assistance while visiting the Gallery.

HOURS

For hours and updated admission information please visit artgalleryofnovascotia.ca/visit-halifax.

BECOME A MEMBER

Join a community that celebrates culture and diversity through the visual arts.

SHARE YOUR EXPERIENCE

Follow the Art Gallery of Nova Scotia on social media @artgalleryns



artgalleryofnovascotia.ca

1723 Hollis Street | Halifax, Nova Scotia | B3J 1V9
902.424.5280 | info.agns@novascotia.ca



Level 3 North

- 14 Bernard Riordon Gallery
- 15 City of Halifax Gallery
- 16 City of Halifax Gallery
- 17/18 Galleries
- 19 Royal Bank Gallery
- 20 Donald G. Grant Gallery
- 21 Frederick and Elizabeth Fountain Gallery
- 22/24 Galleries
- 23 Alice Hoskins Gallery

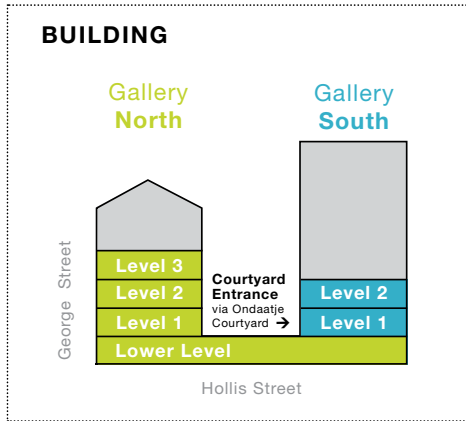
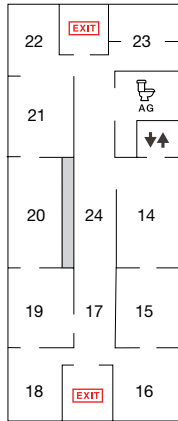

LEGEND

- Ondaatje Courtyard
- Elevator
- Washroom
- All-Gender Washroom
- Water Fountain
- Emergency Exit

Level 2 North

- 9 Jack and Joan Craig Gallery
- 10/11 Galleries
- 12 HRM Millennium Committee and ExxonMobil Canada Gallery
- 13 Anthony and Jane Shaw Law Gallery

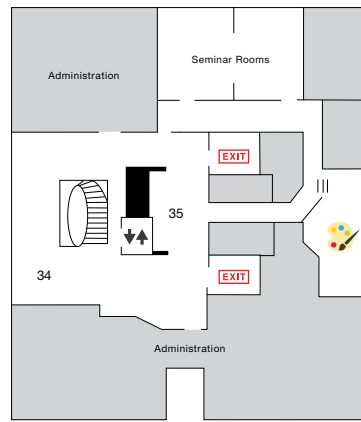
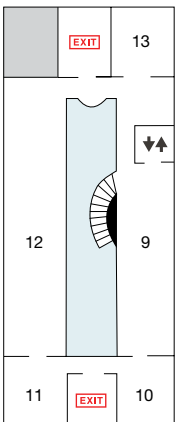

Level 2 South

- 34 Jack and Joan Craig Gallery
- 35 Lloyd and Jean Shaw Gallery
- Jack and Diane Smith Education Studio

Level 1 North

- 4 Fred C. Manning Gallery
- 5 LeRoy and Marguerite Zwicker Gallery
- 6 John and Norma Oyler Gallery
- 7 Sir Christopher Ondaatje Gallery
- 8 Laufer Family Gallery

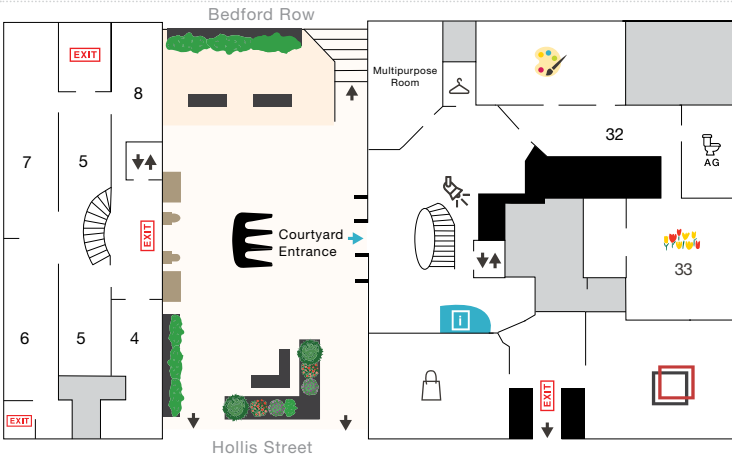

Level 1 South

- 32 Newman Daughters Gallery
- 33 Scotiabank Maud Lewis Gallery
- Teichert Gallery
- Alex, Katharine, Elizabeth & Fred Fountain Gallery Shop
- Welcome Desk
- Southwest Properties Coat Room
- Michelin and the Donald R. Sobey Foundation NS Spotlight
- Barbara and Norman Newman Education Centre Studio

Lower Level

- 1 Central Guaranty Trust Gallery
- 30 Marian deWitt Gallery
- Windsor Foundation Lecture Theatre
- Security Office

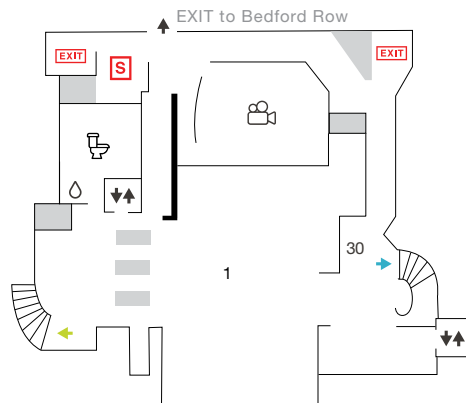

The Art Gallery occupies two buildings, Gallery South and Gallery North and are connected by the Lower Level under the Courtyard. Level 3 in Gallery North is only accessible via the elevator. The exterior elevator signage matches the map and will show you which level you are on.